



Milward Road, Hastings TN34 3RR

Offers in excess of £200,000



A bright and spacious two bedroom GARDEN APARTMENT positioned in a sought after and CENTRAL LOCATION only moments from the beach, Alexandra Park and Hastings Town centre which offers a range of shopping facilities, restaurants and there is a mainline railway station with connections to London. The accommodation here spans the GROUND FLOOR of this period residence and is arranged as a BAY FRONTED LIVING ROOM which is open to the kitchen creating the ideal sociable setting. There are two WELL PROPORTIONED BEDROOMS both positioned at the rear of the property together with a family bathroom where there is a bath with shower and screen over. Externally there is a TIERED REAR GARDEN offering areas of lawn and patio perfect for DINING AL FRESCO along with a handy STORAGE SHED. Set in a SOUGHT AFTER LOCATION, this fantastic property would make the PERFECT FIRST TIME or family home and is not to be missed.

GROUND FLOOR
535 sq.ft. (49.7 sq.m.) approx.

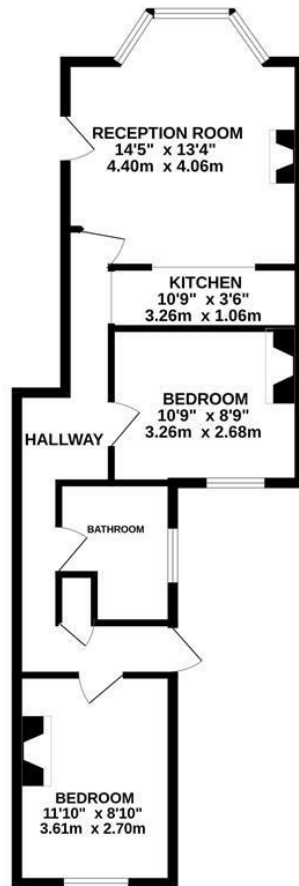

TOTAL FLOOR AREA : 535 sq.ft. (49.7 sq.m.) approx.

Whilst every attempt has been made to ensure the accuracy of the floorplan contained here, measurements of doors, windows, rooms and any other items are approximate and no responsibility is taken for any error, omission or mis-statement. This plan is for illustrative purposes only and should be used as such by any prospective purchaser. The services, systems and appliances shown have not been tested and no guarantee as to their operability or efficiency can be given.
Made with Metropix ©2025

